

DIMENSIONS

MILLIMETERS(INCHES)

CRG-03-06-50 Check Valves (Right Angle)-Subplate Type

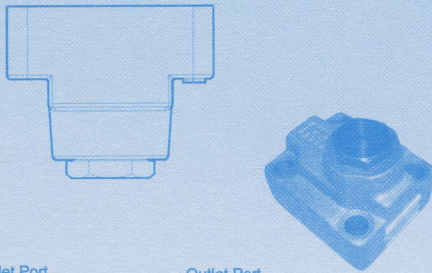

Valve Specifications & Attachment

Model	CRG-03	CRG-06
Flow rating	40 lpm (10.6 gpm)	125 lpm (33 gpm)
Max. Pressure	250 bar (3600 psi)	250 bar (3600 psi)
Weight kg (lbs.)	1.7 (3.8)	2.9 (6.4)
CODE:20	M10 X45LgX4pcs	M10 X50LgX4pcs
CODE:2090	3/8-16UNCX1-3/4LgX4pcs	3/8-16UNCX2LgX4pcs
Surface O-Ring	P22AX2pc	P29X2pc
ISO Mounting	5781-AG-06-2-A	5781-AH-08-2-A

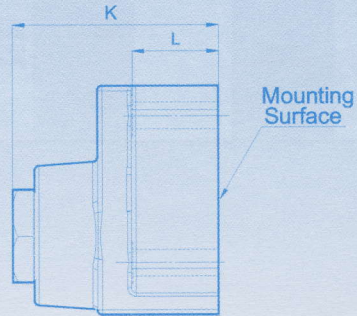
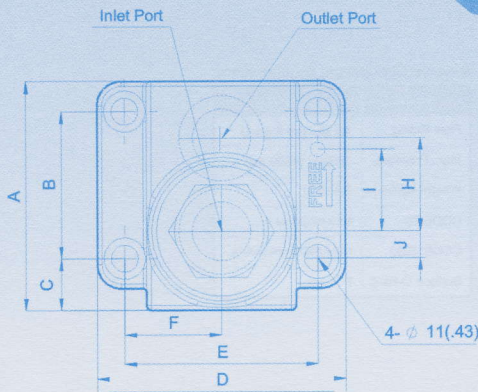

Model	A	B	C	D	E	F	G	H	I	J	K	L
CRG-03-5-50	73(2.87)	42.9(1.68)	18(.70)	89(3.50)	66.7(2.62)	33.4(1.31)	11.2(.44)	35.7(1.40)	31.8(1.25)	7(.27)	68(2.67)	33(1.29)
CRG-06-5-50	94(3.70)	60.3(2.37)	21.5(.84)	102(4.01)	79.4(3.12)	39.7(1.56)	11.3(.44)	49.2(1.93)	44.5(1.75)	11.1(.43)	85(3.34)	35(1.37)

CRG-10-50 Check Valves (Right Angle)-Subplate Type

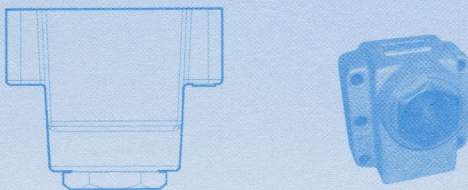

Valve Specifications & Attachment



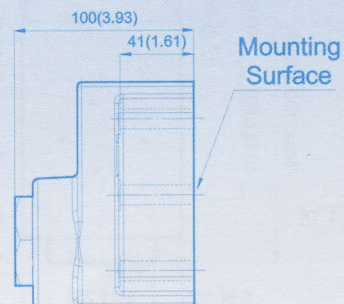
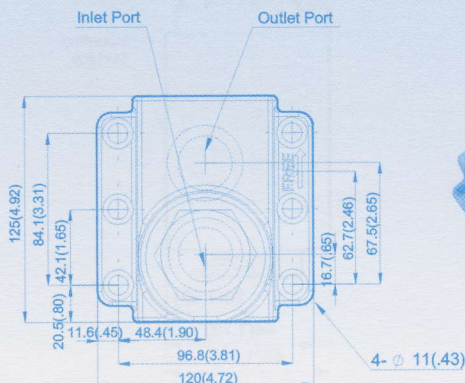
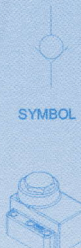

Model	CRG-10
Flow rating	250 lpm (66 gpm)
Max. Pressure	250 bar (3600 psi)
Weight kg (lbs.)	5.5 (12.1)
CODE:20	M10x55LgX8pcs
CODE:2090	3/8-16UNCX2-1/4LgX8pcs
Surface O-Ring	P36X2pc
ISO Mounting	5781-AJ-10-2-A



Cam Operated Directional Valves(Sub-Plate Type)
DCG Series

■ Ordering Code

DC - T - 01 - 2B2 - 20

Series No	Type of Mounting	Valve Size	Spool Type	Design No
DC: Cam Operated Directional Valve	G Subplate Mounting	(DCG-01) (NFFPA-D03)	2B2 	20 (G) DIN 912 bolts 
	T Threaded Connection		2B2 	2090 (G) UNC bolts (North America) 

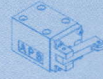
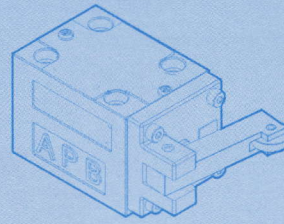

■ Valve Specifications & Attachment

Model	DCG-01
Flow Rating	63 lpm (16.6 gpm)
Max. Pressure	315bar (4500 psi)
Weight kg.(lbs.)	1.4 (3.1)
CODE:20	M5 X45LgX4pcs
CODE:2090	10-24UNCX1-3/4LgX4pcs
Surface O-Ring	P9X4pc

DCG-01 Cam Operated Directional Valves(Sub-Plate Type)

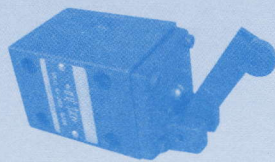

Normal Position

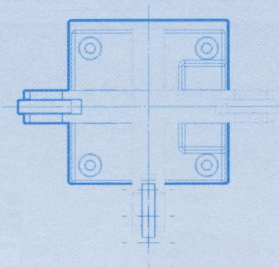

Position "Y"

Position "R"

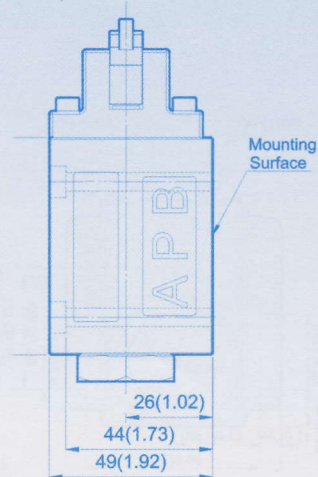
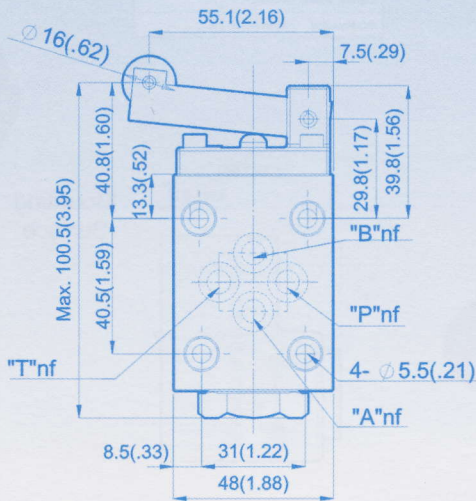
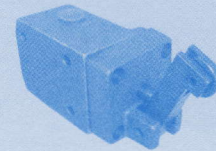











Ordering Code

CP - T - 03 - E - 04 - 20



SYMBOL

Series No	Type of Mounting	Valve Size	Drain Connection	Pressure Range	Design No
CP: Pilot Controlled Check Valve	G Subplate Mounting 	03: (3/8") ISO 5781-AG-06-2-A	None: Internal Drain	04: 0.4 bar (6 PSI)	20 (G) DIN 912 bolts 
CPD: Decompression Type Pilot Controlled Check Valve	T Threaded Connection 	06: (3/4") ISO 5781-AH-08-2-A	E: External Drain	20: 2.0 bar (29 PSI)	2090 (G) UNC bolts (North America) 
CPDG: 		10: (1-1/4") ISO 5781-AJ-10-2-A		35: 3.5 bar (50 PSI)	20 (T) PT Connection 
CPDT: 				50: 5.0 bar (70 PSI)	2090 (T) NPT Connection (North America) 

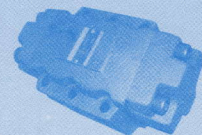
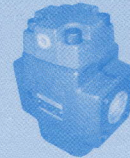

MODEL	DESCRIPTION
CPDG-03-06	Pilot Controlled Check Valves(Sub-Plate Type)
CPDG-10	Pilot Controlled Check Valves(Sub-Plate Type)
CPDT-04-06-10	Pilot Controlled Check Valves(Threaded Type)
CPDF-16	Pilot Controlled Check Valves

CPDG



CPDF

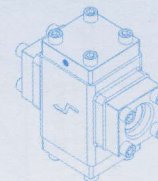

CPDT

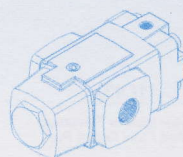

CPDG-03-06 Pilot Controlled Check Valves(Sub-Plate Type)

■ Valve Specifications & Attachment

Model	CPDG-03	CPDG-06
Flow Rating	40 lpm (10.6 gpm)	125 lpm (33 gpm)
Max. Pressure	250 bar (3600 psi)	250 bar (3600 psi)
Weight kg(lbs.)	3.3 (7.3)	5.4 (11.9)
CODE:20	M10 X45LgX4pcs	M10 X50LgX4pcs
CODE:2090	3/8-16UNCX1-3/4LgX4pcs	3/8-16UNCX2LgX4pcs
Surface O-Ring	P9X2pc, P18X2pc	P9X2pc, P25X2pc
ISO Mounting	5781-AG-06-2-A	5781-AH-08-2-A

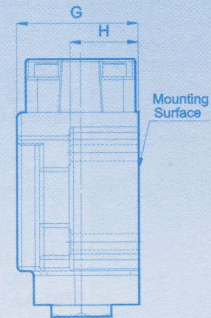
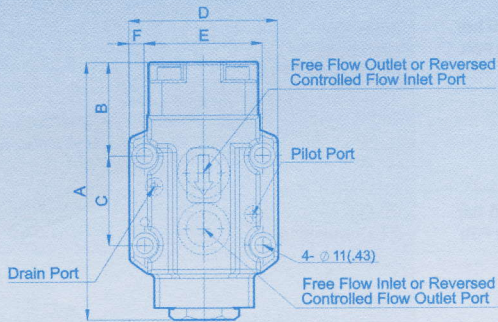
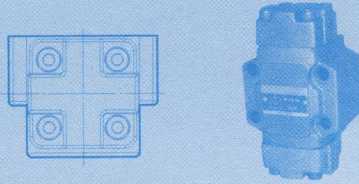

Model	A	B	C	D	E	F	G	H
CPDG-03	148(5.82)	52.6(2.07)	42.9(1.68)	91(3.58)	66.7(2.62)	12.2(.48)	70(2.75)	61(2.40)
CPDG-06	174(6.85)	63.4(2.49)	60.3(2.37)	100(3.93)	79.4(3.12)	10.3(.40)	82(3.22)	46(1.81)
CPDG-03	123(4.84)	37.6(1.48)	42.9(1.68)	85(3.34)	66.7(2.62)	9.2(.36)	45(1.77)	13(.51)

CPDG-10 Pilot Controlled Check Valves(Sub-Plate Type)

■ Valve Specifications & Attachment

Model	CPDG-10
Flow Rating	250 lpm (66 gpm)
Max. Pressure	250 bar (3600 psi)
Weight kg(lbs.)	8.5 (18.7)
CODE:20	M10 X55LgX6pcs
CODE:2090	3/8-16UNCX2-1/4LgX8pcs
Surface O-Ring	P9X2pc, P38X2pc
ISO Mounting	5781-AJ-10-2-A

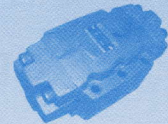
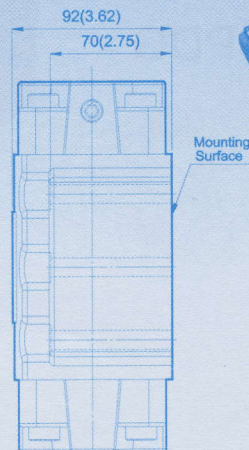
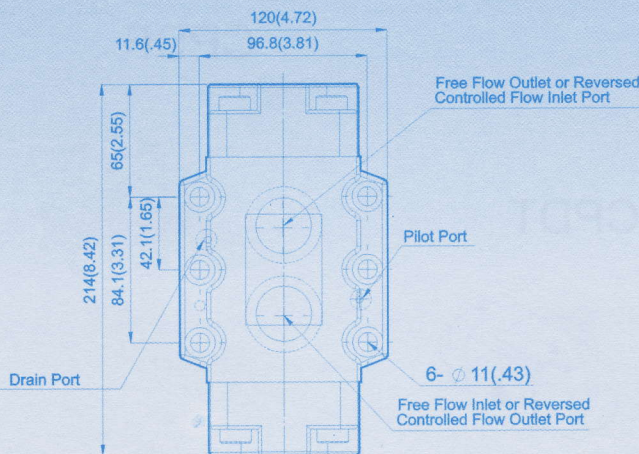
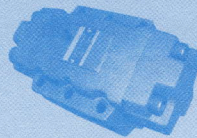
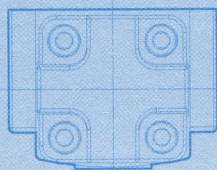



DIMENSIONS

MILLIMETERS(INCHES)

CPDT-04-06-10 Pilot Controlled Check Valves(Threaded Type)

Valve Specifications & Attachment

Model	CPDT-04	CPDT-06	CPDT-10
Flow Rating	40 lpm (10.6 gpm)	125 lpm (33 gpm)	250 lpm (66 gpm)
Max. Pressure	250 bar (3600 psi)	250 bar (3600 psi)	250 bar (3600 psi)
Weight kg.(lbs.)	3.0 (6.6)	5.5 (12.1)	9.6 (21.2)
CODE:20	1/2" PT	3/4" PT	1 1/4" PT
CODE:2090	1/2" NPT	3/4" NPT	1 1/4" NPT



SYMBOL

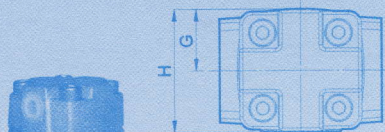
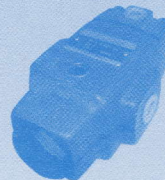

Free Flow Outlet or Reversed Controlled Flow Inlet Port

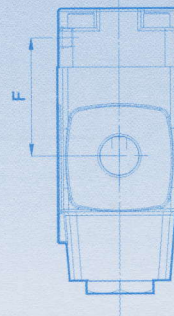
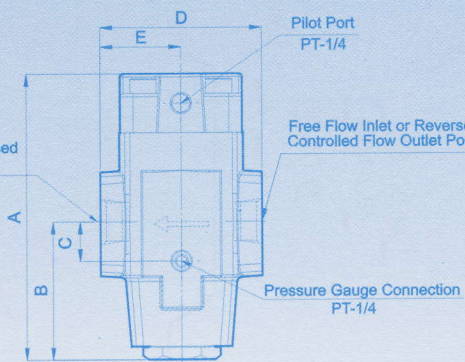

Model	A	B	C	D	E	F	G	H	I
CPDT-04	148(5.82)	74(2.91)	19(.74)	80(3.14)	40(1.57)	59(2.32)	62(2.44)	31(1.22)	1/2
CPDT-06	174(6.85)	84(3.30)	24(.94)	98(3.85)	49(1.92)	72(2.83)	75(2.95)	37.5(1.47)	3/4
CPDT-10	200(7.87)	90.5(3.56)	22.5(.88)	140(5.51)	70(2.75)	92.5(3.64)	92(3.62)	46(1.81)	1 1/4

CPDF-16 Pilot Controlled Check Valves

Valve Specifications & Attachment

Model	CPDF-16
Flow Rating	500 lpm (132 gpm)
Max. Pressure	250 bar (3600 psi)
Weight kg.(lbs.)	30 (66.3)
CODE:20	2" PT
CODE:2090	2" NPT



SYMBOL

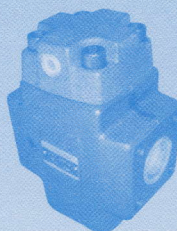
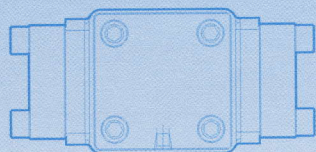

Pressure Gauge Connection PT-1/4

Free Flow Outlet or Reversed Controlled Flow Inlet Port

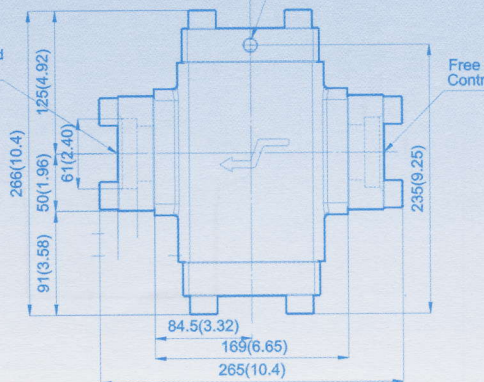

Free Flow Inlet or Reversed Controlled Flow Outlet Port

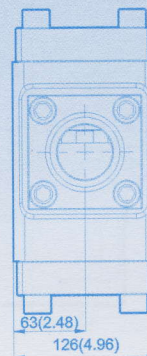

INSTALLATION DIMENSIONS

MILLIMETERS(INCHES)

BG-03-06-10
BRG-03-06-10
SBG-03-06-10

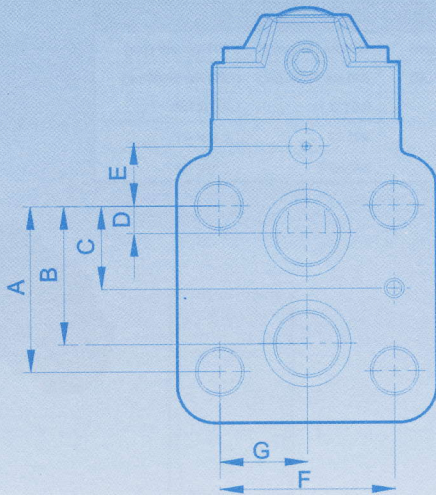

RG-06
HG-06
HCG-06
CPDG-06

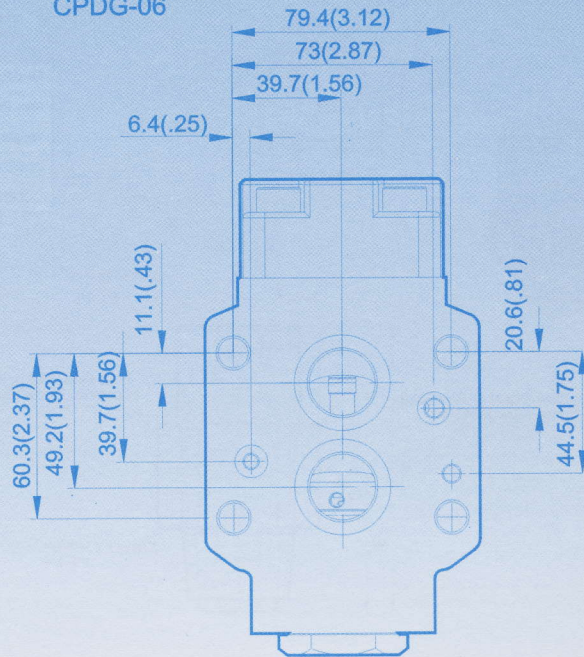

	A	B	C	D	E	F	G
03	53.8(2.11)	47.4(1.86)	22(0.86)	22(0.86)	0	53.8(2.11)	26.9(1.05)
06	66.7(2.62)	55.5(2.18)	33.4(1.31)	11(0.43)	23.8(0.93)	70(2.75)	35(1.37)
10	88.9(3.50)	76.2(3.00)	44.5(1.75)	12.7(.50)	31.8(1.25)	82.6(3.25)	41.3(1.62)

RG-03
HG-03
HCG-03
CPDG-03

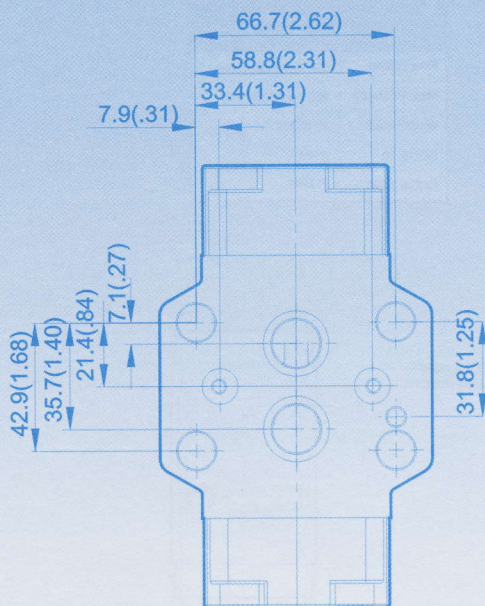

HG-10
HCG-10
CPDG-10

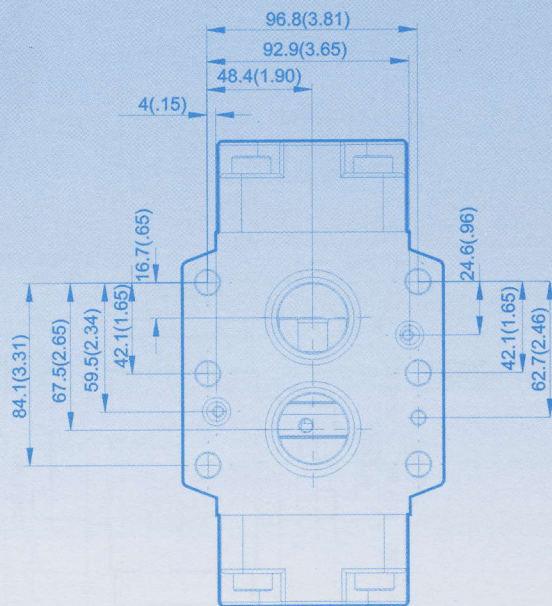









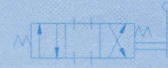



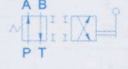

DIRECTION CONTROL VALVES

Ordering Code

DM - T - 03 - 2B2 - 20

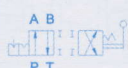

SYMBOL

Series No	Type of Mounting	Valve Size	Pressure Range	Design No
DM: Manually Operated Directional Valves	G Subplate Mounting 	01: (1/8") ISO 4401-AB-03-4-A	2B2 	20 (G) DIN 912 bolts 
DMG: 	T Threaded Connection 	03: (3/8") ISO 4401-AC-05-4-A	2B3 	2090 (G) UNC bolts (North America) 
DMT: 		04: (1/2") ISO 4401-AD-07-4-A	2D2 	20 (T) PT Connection 
		06: (3/4") ISO 4401-AE-08-4-A	3C2 	2090 (T) NPT Connection (North America) 
		10: (1 1/4") ISO 4401-AF-10-4-A	3C60 	

DMG

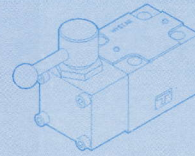

DMT

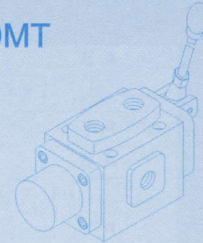

MODEL	DESCRIPTION
DMG-01	Manually Operated Directional Valves(Sub-Plate Type)
DMG-03	Manually Operated Directional Valves(Sub-Plate Type)
DMT-03	Manually Operated Directional Valves(Threaded Type)
DMT-04-06-10	Manually Operated Directional Valves(Threaded Type)

DMG-01

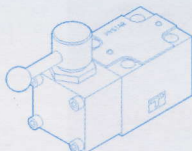

DMG-03

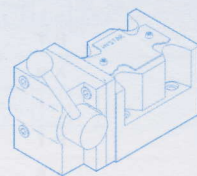

DMG-03-**-10

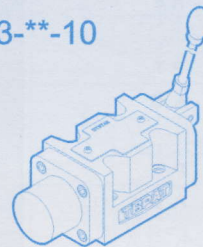

LIST OF SPOOL FUNCTIONS (DMG/T-01/03)

SPRING OFFSET 2 POSITION	GRAPHIC SYMBOLS (STANDARD)	SPRING CENTERED 3 POSITION	GRAPHIC SYMBOLS (STANDARD)	NO SPRING DETENTED 3 POSITION	GRAPHIC SYMBOLS (STANDARD)
2B2		3C2		3D2	
2B3		3C3		3D3	
2B8		3C4		3D4	
2B29		3C40		3D40	
		3C5		3D5	
NO SPRING DETENTED 2 POSITION	GRAPHIC SYMBOLS (STANDARD)	3C6		3D6	
		3C60		3D60	
2D2		3C7		3D7	
2D3		3C8		3D8	
2D4		3C9		3D9	
2D40		3C10		3D10	
2D5		3C11		3D11	
2D60		3C12		3D12	
2D8		3C25		3D25	
2D9		3C29		3D29	
2D10		3C48		3D48	
2D12		3C94		3D94	



DIRECTION CONTROL VALVES

DIMENSIONS

MILLIMETERS(INCHES)

DMG-01-30 Manually Operated Directional Valves(Sub-Plate Type)

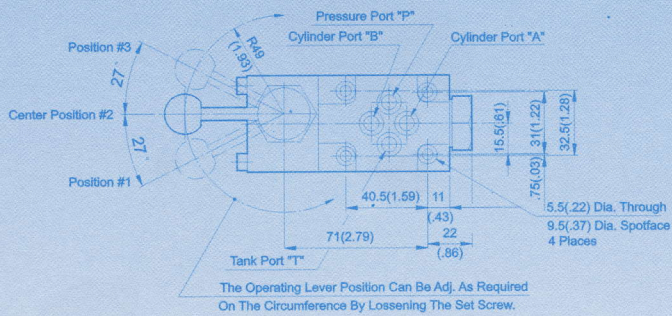

Valve Specifications & Attachment

Model	DMG-01
Flow Rating	63 lpm (16.6 gpm)
Max. Pressure	315 bar (4500 psi)
Weight kg/(lbs.)	1.4 (3.1)
CODE:20	M5 X45LpX4pcs
CODE:2090	10-24UNCX1/34"LpX4pcs
Surface O-Ring	P9X4pc

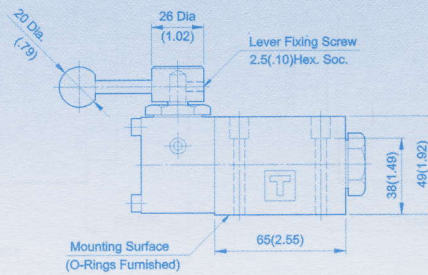
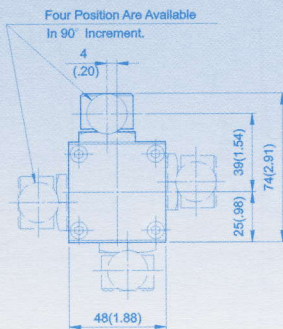
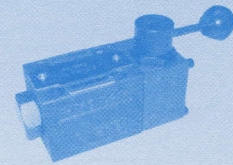

DMG-03-30 Manually Operated Directional Valves(Sub-Plate Type)

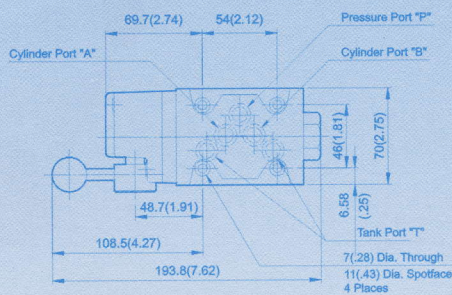

Valve Specifications & Attachment

Model	DMG-03
Flow Rating	120 lpm (31.7 gpm)
Max. Pressure	315 bar (4500 psi)
Weight kg/(lbs.)	3.8 (8.3)
CODE:20	M5 X45LpX4pcs
CODE:2090	10-24UNCX1/34"LpX4pcs
Surface O-Ring	P12X5pc

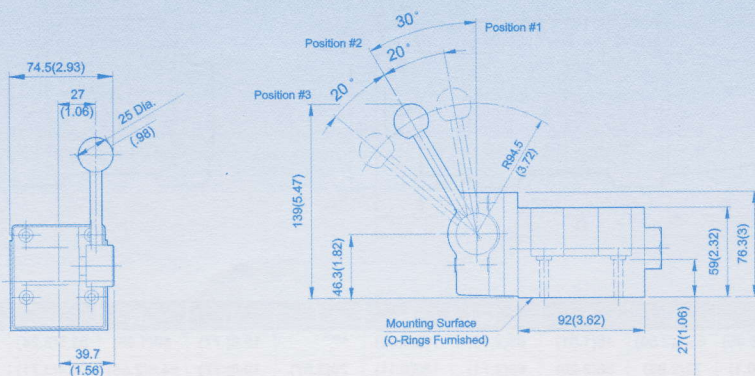
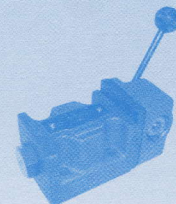

Orifice dia. "ød"
 should be determined by
 customer application

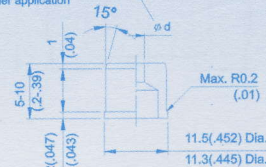

Finishing Dimensions
 of Flow Restrictor
 Scale:4/1

DIMENSIONS

MILLIMETERS(INCHES)

DMT-03 Manually Operated Directional Valves(Threaded Type)

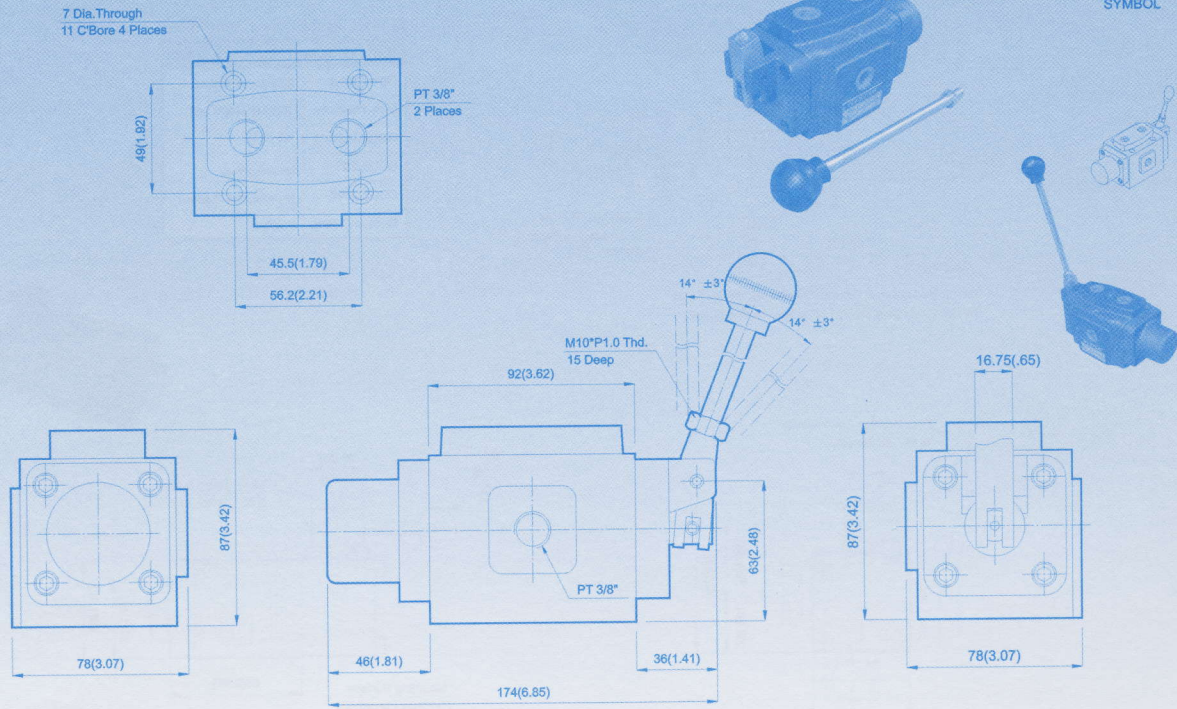

DMT-04-06-10 Manually Operated Directional Valves(Threaded Type)

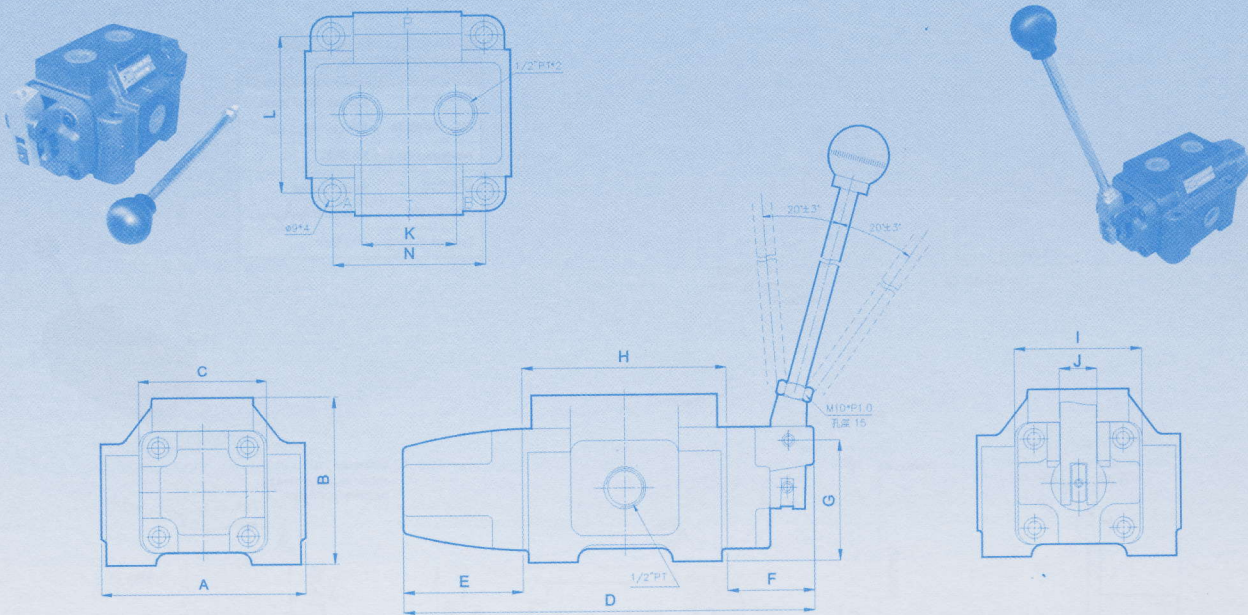

Model	A	B	C	D	E	F	G	H	I	J	K	L	M
DMT-04	107(4.21)	88.5(3.48)	***	227.5(8.95)	63.5(2.50)	46(1.81)	63(2.48)	118(4.64)	***	19.8(.77)	50(1.96)	82.5(3.24)	80.5(3.16)
DMT-06	128(5.03)	99(3.89)	78(3.07)	258(10.1)	72(2.83)	56(2.20)	69(2.71)	130(5.11)	78(3.07)	19.8(.77)	64.8(2.55)	94.4(3.71)	97(3.81)
DMT-10	163(6.41)	121(4.76)	98(3.85)	335(13.1)	94(3.70)	70(2.75)	88.5(3.48)	171(6.73)	99(3.89)	22.7(.89)	79(3.11)	126(4.96)	132.3(5.20)